

.....

# OPTRAL

## DIMENSIONS AND CAPACITY OF THE SPOOLS

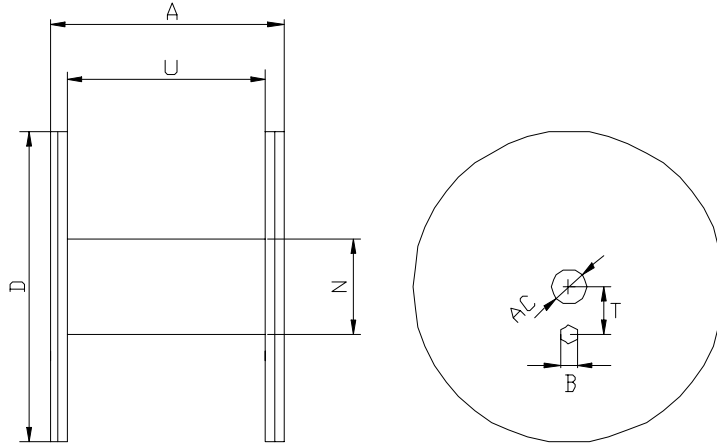

SPOOLS DIMENSIONS								
Type	D	N	A	U	AC	T	B	Weight
FM-60	630	410	275	250	82	100	24	7 Kg
FM-75	750	350	380	350	82	150	24	9 Kg
FM-80	800	400	485	460	82	150	50	11 Kg
FM-105	1050	530	650	620	80	150	50	23 Kg
R-100	1000	500	705	610	82	160	50	51 Kg
R-120	1250	600	805	710	82	160	63	75 Kg
R-140	1400	700	920	810	82	160	63	130 Kg
R-160	1600	900	1100	980	82	160	63	200 Kg

CAPACITY OF THE SPOOLS								
Diameter (mm)	FM60	FM-75	FM80	FM-105	R-100	R-120	R-140	R-160
3	4000	---	---	---	---	---	---	---
4	2260	5100	---	---	---	---	---	---
5	1500	3300	5300	---	---	---	---	---
6	980	2300	3700	---	---	---	---	---
7	730	1700	2700	5500	5500	---	---	---
8	550	1250	2000	4300	4300	---	---	---
9	440	980	1600	3350	3350	5700	---	---
10	---	860	1370	2800	2800	4500	---	---
11	---	650	1000	2300	2300	3750	6300	---
12	---	570	900	1800	1800	3100	5400	---
13	---	470	770	1600	1600	2700	4600	6700
14	---	410	650	1400	1400	2200	3850	5700
15	---	---	620	1200	1200	2000	3500	5100
16	---	---	525	1050	1050	1750	2900	4250
17	---	---	---	900	900	1500	2600	3800
18	---	---	---	850	850	1450	2300	3350
19	---	---	---	750	750	1250	2000	3000
20	---	---	---	710	710	1100	1950	2800

Todas las especificaciones sujetas a cambio sin previo aviso. Consultar a OPTRAL las ediciones en vigor.

.....